

Preliminary courses.
 Course Designer reserves the right to make changes if
 Necessary, changes made will be on the course
 Plan posted at the ingate board

2025 ESP SPRING 2 USEF "A" HUNTER 6* CSI 3*

April 9-13, 2025

Competition No.: 708

\$5,000 1.40 jr/am jumper classic

Competition with one jump-off

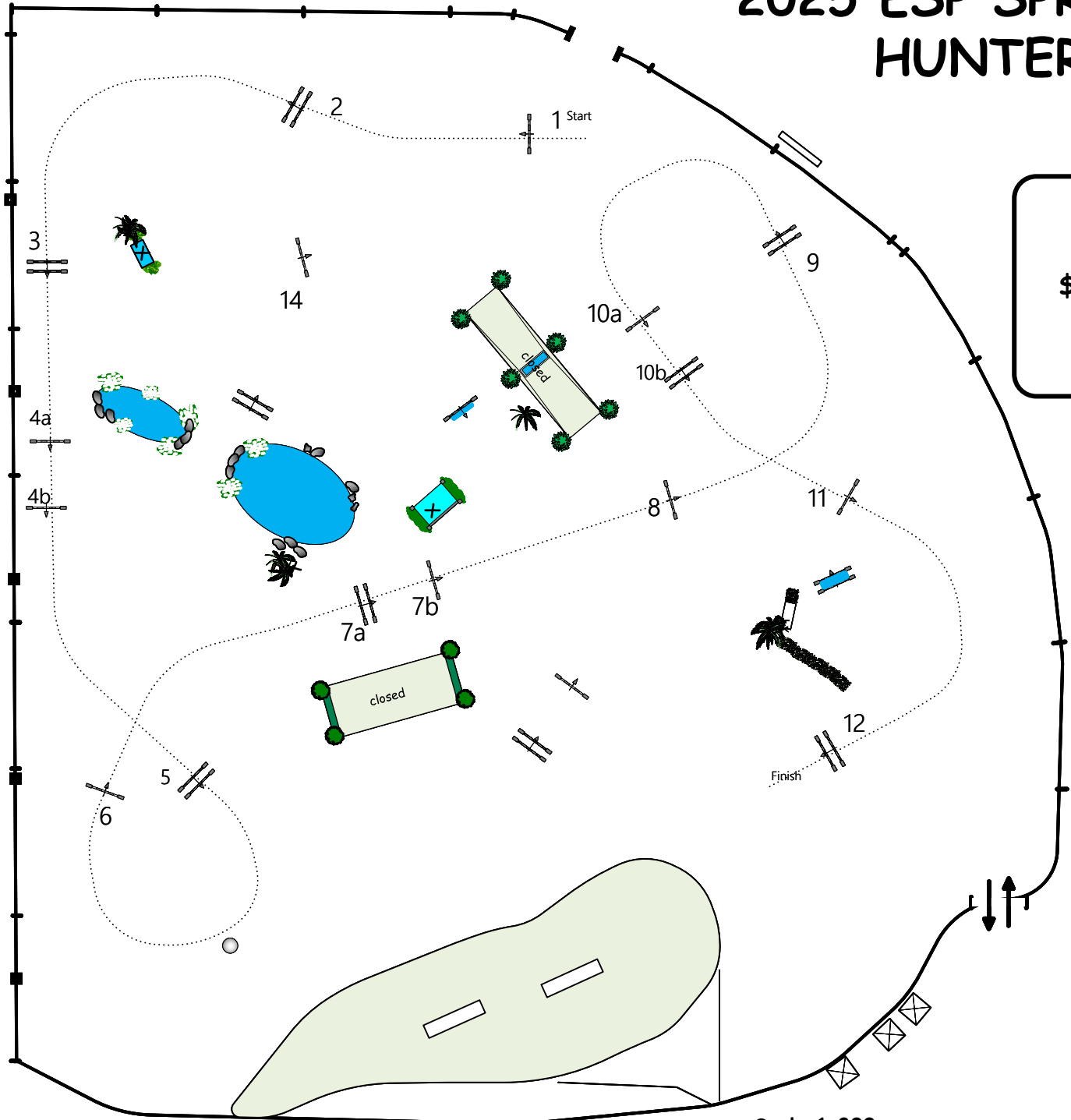

Table: A
 National RG: II 2B
 FEI RG / Art.
 Height: 1.40 m

Speed: 350 m/min
 Length: 0 m
 Time allowed: 0 sec
 Time limit: 0 sec

Obstacles: 1-12
 Efforts: 15

1st Jump-off:
1-2-14-10a-10b-11-12

Length: 250 m
 Time allowed: 43 sec
 Time limit: 86 sec

Sunday April 13, 2025

Course Designer :
 Catsy Cruz



Scale 1:800

Preliminary courses.
 Course Designer reserves the right to make changes if
 Necessary, changes made will be on the course
 Plan posted at the ingate board

2025 ESP SPRING 2 USEF "A" HUNTER 6* CSI 3*

April 9-13, 2025

Competition No.: 3014
FEI \$120,000 GP CSI 3*
Competition with one jump-off

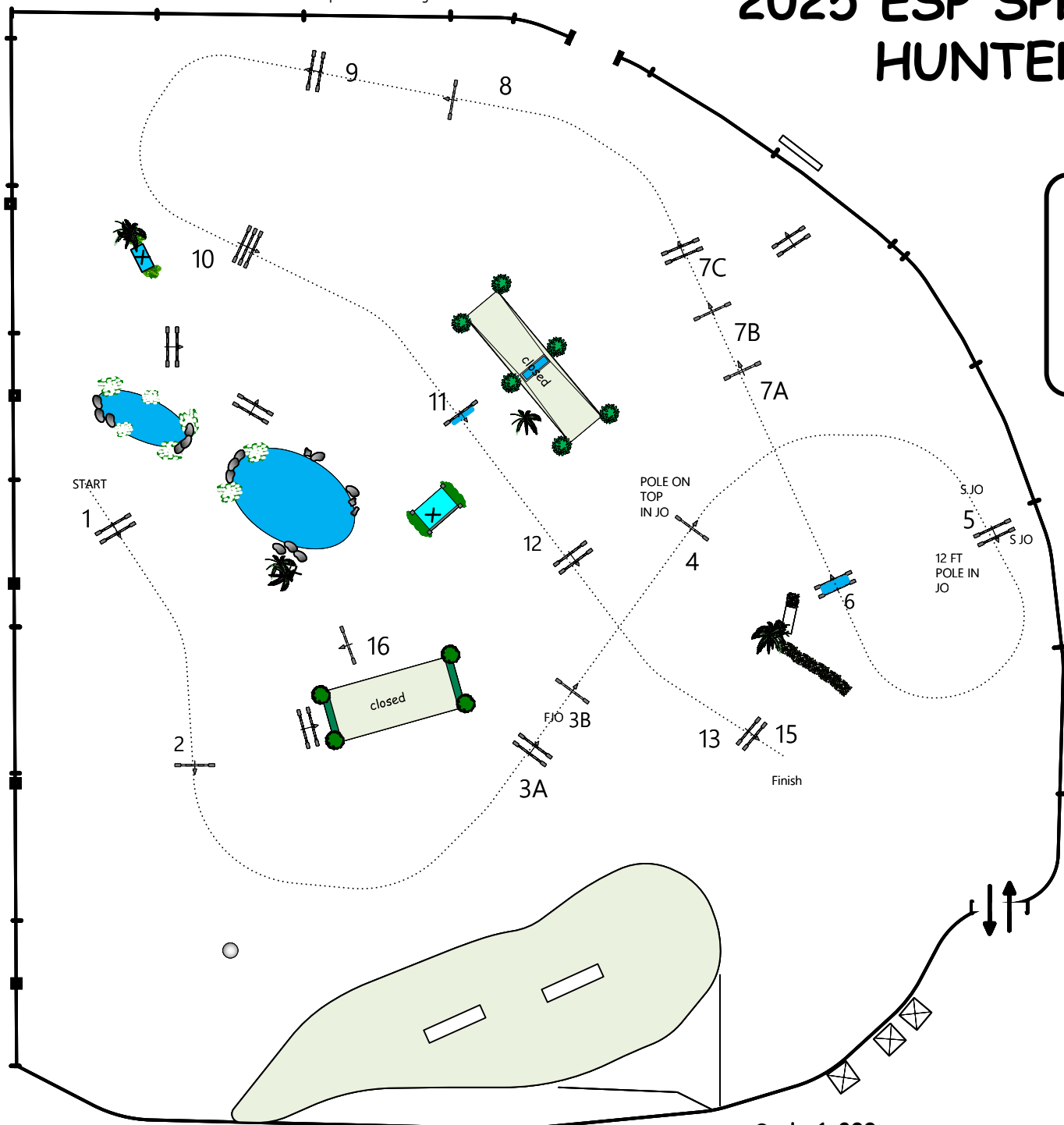

Table: A
 National RG:
 FEI RG / Art. 238 2.2
 Height: 1.50 m

Speed: 375 m/min
 Length: 0 m
 Time allowed: 0 sec
 Time limit: 0 sec

Obstacles: 1-13
 Efforts: 16

1st Jump-off:
5-15-4-7B-7C-11-16-3A
 Length: 345 m
 Time allowed: 56 sec
 Time limit: 112 sec

Sunday April 13, 2025

Course Designer :
 Catsy Cruz



Scale 1:800

Preliminary courses.
 Course Designer reserves the right to make changes if
 Necessary, changes made will be on the course
 Plan posted at the ingate board

2025 ESP SPRING 2 USEF "A" HUNTER 6* CSI 3*

April 9-13, 2025

Competition No.: 804

\$35,000 Spring 2 GP

Competition with one jump-off

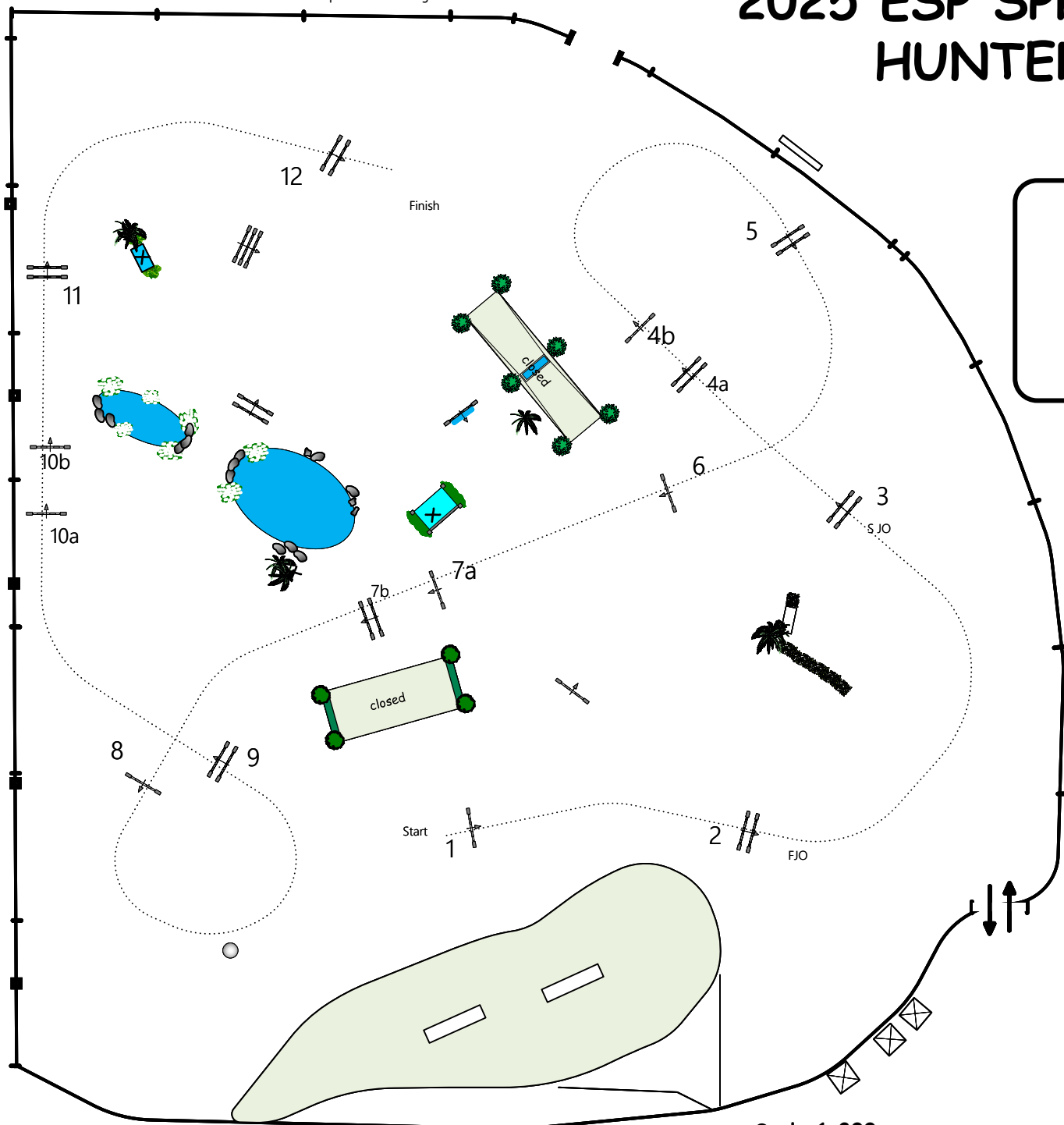

Table: A
 National RG: II 2 a
 FEI RG / Art.
 Height: NS m

Speed: 375 m/min
 Length: 0 m
 Time allowed: 0 sec
 Time limit: 0 sec

Obstacles: 1-12
 Efforts: 15

1st Jump-off:
3-4b-5-6-7a-7b-1-2

Length: 290 m
 Time allowed: 47 sec
 Time limit: 94 sec

Sunday April 13, 2025

Course Designer :
 Catsy Cruz



Scale 1:800