

2025 ESP Spring 4

Friday, May 2, 2025

Class: 701 - 1.40m Open Jumper II2d
771 - 1.30m Open Jumper II2d
773 - 1.30m Junior/Amateur Jumper II2d

Table: II.2.d

First Round: 1 to 6

Length: 290 Meters

Time Allowed: 50 sec

Jump-off: 7-12

Length: 260 Meters

Time Allowed: 45 Sec

ESP Course Maps



Course Designer: Héctor J Loyola (PUR)
FEI Level 3 #10050870
hectorloyola@gmail.com
787-379-1887

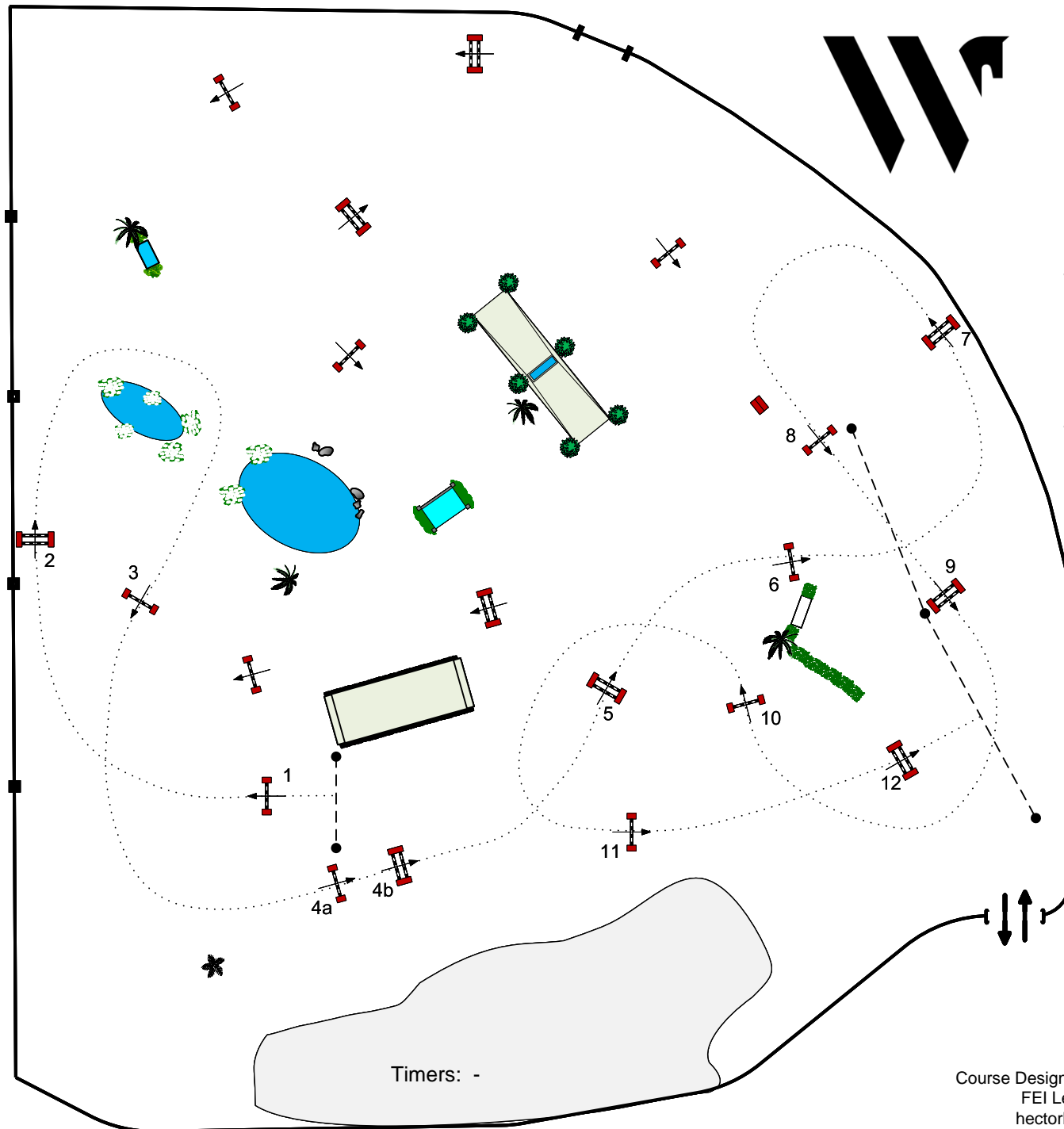

2025 ESP Spring 4

Friday, May 2, 2025

Class: 807 - \$10,000 1.40m Open Stake II2b

Table: II.2.b

First Round: 1 to 12

Length: 460 Meters

Time Allowed: 79 sec

Jump-off: 1-13-9-14-15-10ab-16

Length: 280 Meters

Time Allowed: 48 Sec

ESP Course Maps



Course Designer: Héctor J Loyola (PUR)
FEI Level 3 #10050870
hectorloyola@gmail.com
787-379-1887

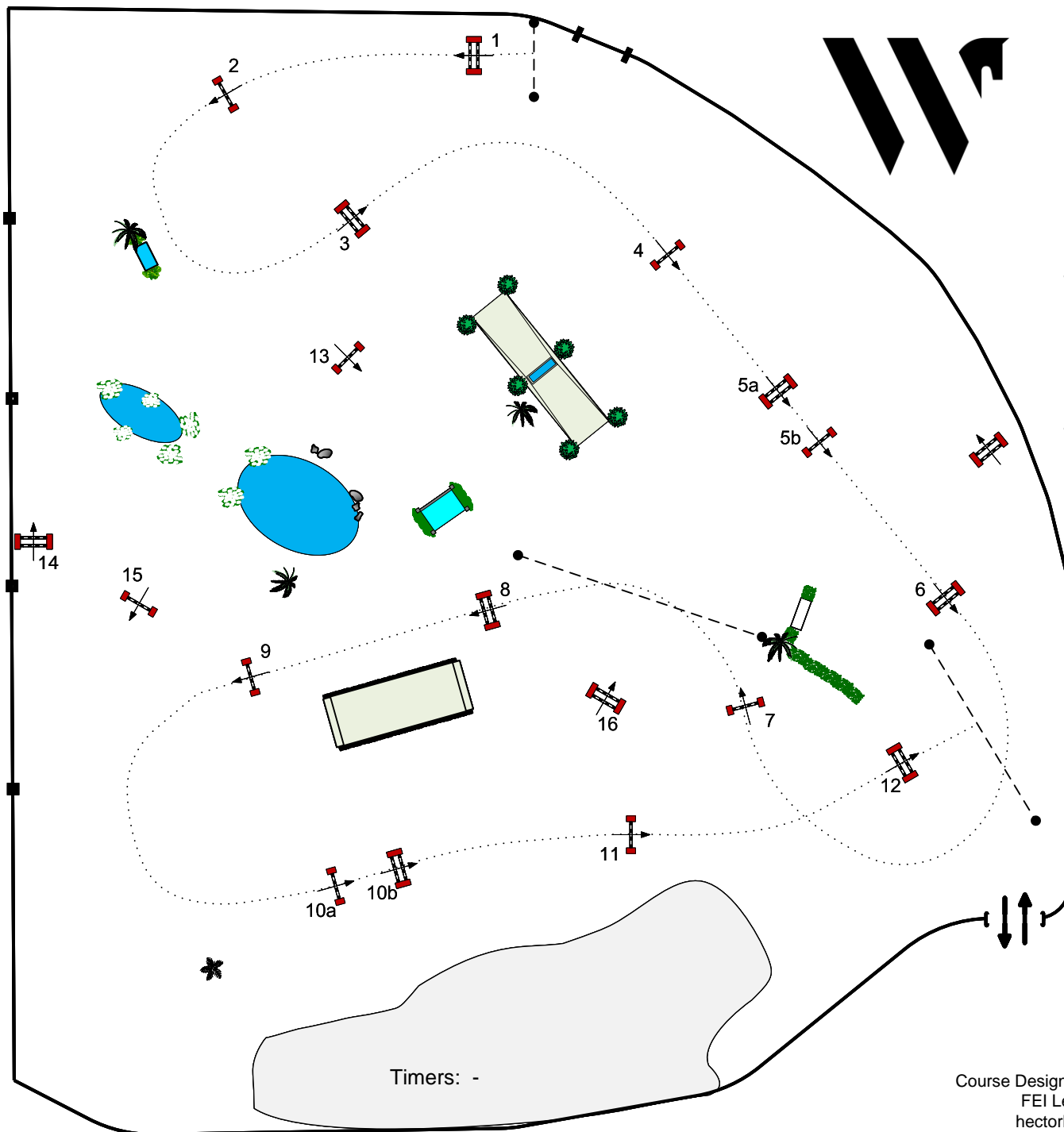

2025 ESP Spring 4

Friday, May 2, 2025

Class: 711 - 1.25m Open Jumper II2d

Table: II.2.d

First Round: 1 to

Length: Meters

Time Allowed: sec

Jump-off:

Length: Meters

Time Allowed: Sec

ESP Course Maps



Course Designer: Héctor J Loyola (PUR)
FEI Level 3 #10050870
hectorloyola@gmail.com
787-379-1887

